

TRAVERSAMENTI DI TUBI METALLICI RIVESTITI  
CON GUAINA ELASTOMERICA  
LAMINA ANTI FUOCO HILTI CFS-B O EQUIVALENTE  
PER TRAVASAMENTI A PARETE E A SOFFITTO

LEGENDA REI	
	PARETI E SOLAI REI 60"
	PARETI E SOLAI REI 120"

ISOLAMENTI TERMICI TUBAZIONI IMPIANTO DI RISCALDAMENTO				
Montare giunto per latrine e elastomeri nella classe di reazione al fuoco A2-s1, A2-s2, A2-s3, A2-s4, A2-s5, A2-s6, A2-s7, A2-s8, A2-s9, A2-s10, A2-s11, A2-s12, A2-s13, A2-s14, A2-s15, A2-s16, A2-s17, A2-s18, A2-s19, A2-s20, A2-s21, A2-s22, A2-s23, A2-s24, A2-s25, A2-s26, A2-s27, A2-s28, A2-s29, A2-s30, A2-s31, A2-s32, A2-s33, A2-s34, A2-s35, A2-s36, A2-s37, A2-s38, A2-s39, A2-s40, A2-s41, A2-s42, A2-s43, A2-s44, A2-s45, A2-s46, A2-s47, A2-s48, A2-s49, A2-s50, A2-s51, A2-s52, A2-s53, A2-s54, A2-s55, A2-s56, A2-s57, A2-s58, A2-s59, A2-s60, A2-s61, A2-s62, A2-s63, A2-s64, A2-s65, A2-s66, A2-s67, A2-s68, A2-s69, A2-s70, A2-s71, A2-s72, A2-s73, A2-s74, A2-s75, A2-s76, A2-s77, A2-s78, A2-s79, A2-s80, A2-s81, A2-s82, A2-s83, A2-s84, A2-s85, A2-s86, A2-s87, A2-s88, A2-s89, A2-s90, A2-s91, A2-s92, A2-s93, A2-s94, A2-s95, A2-s96, A2-s97, A2-s98, A2-s99, A2-s100, A2-s101, A2-s102, A2-s103, A2-s104, A2-s105, A2-s106, A2-s107, A2-s108, A2-s109, A2-s110, A2-s111, A2-s112, A2-s113, A2-s114, A2-s115, A2-s116, A2-s117, A2-s118, A2-s119, A2-s120, A2-s121, A2-s122, A2-s123, A2-s124, A2-s125, A2-s126, A2-s127, A2-s128, A2-s129, A2-s130, A2-s131, A2-s132, A2-s133, A2-s134, A2-s135, A2-s136, A2-s137, A2-s138, A2-s139, A2-s140, A2-s141, A2-s142, A2-s143, A2-s144, A2-s145, A2-s146, A2-s147, A2-s148, A2-s149, A2-s150, A2-s151, A2-s152, A2-s153, A2-s154, A2-s155, A2-s156, A2-s157, A2-s158, A2-s159, A2-s160, A2-s161, A2-s162, A2-s163, A2-s164, A2-s165, A2-s166, A2-s167, A2-s168, A2-s169, A2-s170, A2-s171, A2-s172, A2-s173, A2-s174, A2-s175, A2-s176, A2-s177, A2-s178, A2-s179, A2-s180, A2-s181, A2-s182, A2-s183, A2-s184, A2-s185, A2-s186, A2-s187, A2-s188, A2-s189, A2-s190, A2-s191, A2-s192, A2-s193, A2-s194, A2-s195, A2-s196, A2-s197, A2-s198, A2-s199, A2-s200, A2-s201, A2-s202, A2-s203, A2-s204, A2-s205, A2-s206, A2-s207, A2-s208, A2-s209, A2-s210, A2-s211, A2-s212, A2-s213, A2-s214, A2-s215, A2-s216, A2-s217, A2-s218, A2-s219, A2-s220, A2-s221, A2-s222, A2-s223, A2-s224, A2-s225, A2-s226, A2-s227, A2-s228, A2-s229, A2-s230, A2-s231, A2-s232, A2-s233, A2-s234, A2-s235, A2-s236, A2-s237, A2-s238, A2-s239, A2-s240, A2-s241, A2-s242, A2-s243, A2-s244, A2-s245, A2-s246, A2-s247, A2-s248, A2-s249, A2-s250, A2-s251, A2-s252, A2-s253, A2-s254, A2-s255, A2-s256, A2-s257, A2-s258, A2-s259, A2-s260, A2-s261, A2-s262, A2-s263, A2-s264, A2-s265, A2-s266, A2-s267, A2-s268, A2-s269, A2-s270, A2-s271, A2-s272, A2-s273, A2-s274, A2-s275, A2-s276, A2-s277, A2-s278, A2-s279, A2-s280, A2-s281, A2-s282, A2-s283, A2-s284, A2-s285, A2-s286, A2-s287, A2-s288, A2-s289, A2-s290, A2-s291, A2-s292, A2-s293, A2-s294, A2-s295, A2-s296, A2-s297, A2-s298, A2-s299, A2-s300, A2-s301, A2-s302, A2-s303, A2-s304, A2-s305, A2-s306, A2-s307, A2-s308, A2-s309, A2-s310, A2-s311, A2-s312, A2-s313, A2-s314, A2-s315, A2-s316, A2-s317, A2-s318, A2-s319, A2-s320, A2-s321, A2-s322, A2-s323, A2-s324, A2-s325, A2-s326, A2-s327, A2-s328, A2-s329, A2-s330, A2-s331, A2-s332, A2-s333, A2-s334, A2-s335, A2-s336, A2-s337, A2-s338, A2-s339, A2-s340, A2-s341, A2-s342, A2-s343, A2-s344, A2-s345, A2-s346, A2-s347, A2-s348, A2-s349, A2-s350, A2-s351, A2-s352, A2-s353, A2-s354, A2-s355, A2-s356, A2-s357, A2-s358, A2-s359, A2-s360, A2-s361, A2-s362, A2-s363, A2-s364, A2-s365, A2-s366, A2-s367, A2-s368, A2-s369, A2-s370, A2-s371, A2-s372, A2-s373, A2-s374, A2-s375, A2-s376, A2-s377, A2-s378, A2-s379, A2-s380, A2-s381, A2-s382, A2-s383, A2-s384, A2-s385, A2-s386, A2-s387, A2-s388, A2-s389, A2-s390, A2-s391, A2-s392, A2-s393, A2-s394, A2-s395, A2-s396, A2-s397, A2-s398, A2-s399, A2-s400, A2-s401, A2-s402, A2-s403, A2-s404, A2-s405, A2-s406, A2-s407, A2-s408, A2-s409, A2-s410, A2-s411, A2-s412, A2-s413, A2-s414, A2-s415, A2-s416, A2-s417, A2-s418, A2-s419, A2-s420, A2-s421, A2-s422, A2-s423, A2-s424, A2-s425, A2-s426, A2-s427, A2-s428, A2-s429, A2-s430, A2-s431, A2-s432, A2-s433, A2-s434, A2-s435, A2-s436, A2-s437, A2-s438, A2-s439, A2-s440, A2-s441, A2-s442, A2-s443, A2-s444, A2-s445, A2-s446, A2-s447, A2-s448, A2-s449, A2-s450, A2-s451, A2-s452, A2-s453, A2-s454, A2-s455, A2-s456, A2-s457, A2-s458, A2-s459, A2-s460, A2-s461, A2-s462, A2-s463, A2-s464, A2-s465, A2-s466, A2-s467, A2-s468, A2-s469, A2-s470, A2-s471, A2-s472, A2-s473, A2-s474, A2-s475, A2-s476, A2-s477, A2-s478, A2-s479, A2-s480, A2-s481, A2-s482, A2-s483, A2-s484, A2-s485, A2-s486, A2-s487, A2-s488, A2-s489, A2-s490, A2-s491, A2-s492, A2-s493, A2-s494, A2-s495, A2-s496, A2-s497, A2-s498, A2-s499, A2-s500, A2-s501, A2-s502, A2-s503, A2-s504, A2-s505, A2-s506, A2-s507, A2-s508, A2-s509, A2-s510, A2-s511, A2-s512, A2-s513, A2-s514, A2-s515, A2-s516, A2-s517, A2-s518, A2-s519, A2-s520, A2-s521, A2-s522, A2-s523, A2-s524, A2-s525, A2-s526, A2-s527, A2-s528, A2-s529, A2-s530, A2-s531, A2-s532, A2-s533, A2-s534, A2-s535, A2-s536, A2-s537, A2-s538, A2-s539, A2-s540, A2-s541, A2-s542, A2-s543, A2-s544, A2-s545, A2-s546, A2-s547, A2-s548, A2-s549, A2-s550, A2-s551, A2-s552, A2-s553, A2-s554, A2-s555, A2-s556, A2-s557, A2-s558, A2-s559, A2-s560, A2-s561, A2-s562, A2-s563, A2-s564, A2-s565, A2-s566, A2-s567, A2-s568, A2-s569, A2-s570, A2-s571, A2-s572, A2-s573, A2-s574, A2-s575, A2-s576, A2-s577, A2-s578, A2-s579, A2-s580, A2-s581, A2-s582, A2-s583, A2-s584, A2-s585, A2-s586, A2-s587, A2-s588, A2-s589, A2-s590, A2-s591, A2-s592, A2-s593, A2-s594, A2-s595, A2-s596, A2-s597, A2-s598, A2-s599, A2-s600, A2-s601, A2-s602, A2-s603, A2-s604, A2-s605, A2-s606, A2-s607, A2-s608, A2-s609, A2-s610, A2-s611, A2-s612, A2-s613, A2-s614, A2-s615, A2-s616, A2-s617, A2-s618, A2-s619, A2-s620, A2-s621, A2-s622, A2-s623, A2-s624, A2-s625, A2-s626, A2-s627, A2-s628, A2-s629, A2-s630, A2-s631, A2-s632, A2-s633, A2-s634, A2-s635, A2-s636, A2-s637, A2-s638, A2-s639, A2-s640, A2-s641, A2-s642, A2-s643, A2-s644, A2-s645, A2-s646, A2-s647, A2-s648, A2-s649, A2-s650, A2-s651, A2-s652, A2-s653, A2-s654, A2-s655, A2-s656, A2-s657, A2-s658, A2-s659, A2-s660, A2-s661, A2-s662, A2-s663, A2-s664, A2-s665, A2-s666, A2-s667, A2-s668, A2-s669, A2-s670, A2-s671, A2-s672, A2-s673, A2-s674, A2-s675, A2-s676, A2-s677, A2-s678, A2-s679, A2-s680, A2-s681, A2-s682, A2-s683, A2-s684, A2-s685, A2-s686, A2-s687, A2-s688, A2-s689, A2-s690, A2-s691, A2-s692, A2-s693, A2-s694, A2-s695, A2-s696, A2-s697, A2-s698, A2-s699, A2-s700, A2-s701, A2-s702, A2-s703, A2-s704, A2-s705, A2-s706, A2-s707, A2-s708, A2-s709, A2-s710, A2-s711, A2-s712, A2-s713, A2-s714, A2-s715, A2-s716, A2-s717, A2-s718, A2-s719, A2-s720, A2-s721, A2-s722, A2-s723, A2-s724, A2-s725, A2-s726, A2-s727, A2-s728, A2-s729, A2-s730, A2-s731, A2-s732, A2-s733, A2-s734, A2-s735, A2-s736, A2-s737, A2-s738, A2-s739, A2-s740, A2-s741, A2-s742, A2-s743, A2-s744, A2-s745, A2-s746, A2-s747, A2-s748, A2-s749, A2-s750, A2-s751, A2-s752, A2-s753, A2-s754, A2-s755, A2-s756, A2-s757, A2-s758, A2-s759, A2-s760, A2-s761, A2-s762, A2-s763, A2-s764, A2-s765, A2-s766, A2-s767, A2-s768, A2-s769, A2-s770, A2-s771, A2-s772, A2-s773, A2-s774, A2-s775, A2-s776, A2-s777, A2-s778, A2-s779, A2-s780, A2-s781, A2-s782, A2-s783, A2-s784, A2-s785, A2-s786, A2-s787, A2-s788, A2-s789, A2-s790, A2-s791, A2-s792, A2-s793, A2-s794, A2-s795, A2-s796, A2-s797, A2-s798, A2-s799, A2-s800, A2-s801, A2-s802, A2-s803, A2-s804, A2-s805, A2-s806, A2-s807, A2-s808, A2-s809, A2-s810, A2-s811, A2-s812, A2-s813, A2-s814, A2-s815, A2-s816, A2-s817, A2-s818, A2-s819, A2-s820, A2-s821, A2-s822, A2-s823, A2-s824, A2-s825, A2-s826, A2-s827, A2-s828, A2-s829, A2-s830, A2-s831, A2-s832, A2-s833, A2-s834, A2-s835, A2-s836, A2-s837, A2-s838, A2-s839, A2-s840, A2-s841, A2-s842, A2-s843, A2-s844, A2-s845, A2-s846, A2-s847, A2-s848, A2-s849, A2-s850, A2-s851, A2-s852, A2-s853, A2-s854, A2-s855, A2-s856, A2-s857, A2-s858, A2-s859, A2-s860, A2-s861, A2-s862, A2-s863, A2-s864, A2-s865, A2-s866, A2-s867, A2-s868, A2-s869, A2-s870, A2-s871, A2-s872, A2-s873, A2-s874, A2-s875, A2-s876, A2-s877, A2-s878, A2-s879, A2-s880, A2-s881, A2-s882, A2-s883, A2-s884, A2-s885, A2-s886, A2-s887, A2-s888, A2-s889, A2-s890, A2-s891, A2-s892, A2-s893, A2-s894, A2-s895, A2-s896, A2-s897, A2-s898, A2-s899, A2-s900, A2-s901, A2-s902, A2-s903, A2-s904, A2-s905, A2-s906, A2-s907, A2-s908, A2-s909, A2-s910, A2-s911, A2-s912, A2-s913, A2-s914, A2-s915, A2-s916, A2-s917, A2-s918, A2-s919, A2-s920, A2-s921, A2-s922, A2-s923, A2-s924, A2-s925, A2-s926, A2-s927, A2-s928, A2-s929, A2-s930, A2-s931, A2-s932, A2-s933, A2-s934, A2-s935, A2-s936, A2-s937, A2-s938, A2-s939, A2-s940, A2-s941, A2-s942, A2-s943, A2-s944, A2-s945, A2-s946, A2-s947, A2-s948, A2-s949, A2-s950, A2-s951, A2-s952, A2-s953, A2-s954, A2-s955, A2-s956, A2-s957, A2-s958, A2-s959, A2-s960, A2-s961, A2-s962, A2-s963, A2-s964, A2-s965, A2-s966, A2-s967, A2-s968, A2-s969, A2-s970, A2-s971, A2-s972, A2-s973, A2-s974, A2-s975, A2-s976, A2-s977, A2-s978, A2-s979, A2-s980, A2-s981, A2-s982, A2-s983, A2-s984, A2-s985, A2-s986, A2-s987, A2-s988, A2-s989, A2-s990, A2-s991, A2-s992, A2-s993, A2-s994, A2-s995, A2-s996, A2-s997, A2-s998, A2-s999, A2-s1000, A2-s1001, A2-s1002, A2-s1003, A2-s1004, A2-s1005, A2-s1006, A2-s1007, A2-s1008, A2-s1009, A2-s1010, A2-s1011, A2-s1012, A2-s1013, A2-s1014, A2-s1015, A2-s1016, A2-s1017, A2-s1018, A2-s1019, A2-s1020, A2-s1021, A2-s1022, A2-s1023, A2-s1024, A2-s1025, A2-s1026, A2-s1027, A2-s1028, A2-s1029, A2-s1030, A2-s1031, A2-s1032, A2-s1033, A2-s1034, A2-s1035, A2-s1036, A2-s1037, A2-s1038, A2-s1039, A2-s1040, A2-s1041, A2-s1042, A2-s1043, A2-s1044, A2-s1045, A2-s1046, A2-s1047, A2-s1048, A2-s1049, A2-s1050, A2-s1051, A2-s1052, A2-s1053, A2-s1054, A2-s1055, A2-s1056, A2-s1057, A2-s1058, A2-s1059, A2-s1060, A2-s1061, A2-s1062, A2-s1063, A2-s1064, A2-s1065, A2-s1066, A2-s1067, A2-s1068, A2-s1069, A2-s1070, A2-s1071, A2-s1072, A2-s1073, A2-s1074, A2-s1075, A2-s1076, A2-s1077, A2-s1078, A2-s1079, A2-s1080, A2-s1081, A2-s1082, A2-s1083, A2-s1084, A2-s1085, A2-s1086, A2-s1087, A2-s1088, A2-s1089, A2-s1090, A2-s1091, A2-s1092, A2-s1093, A2-s1094, A2-s1095, A2-s1096, A2-s1097, A2-s1098, A2-s1099, A2-s1100, A2-s1101, A2-s1102, A2-s1103, A2-s1104, A2-s1105, A2-s1106, A2-s1107, A2-s1108, A2-s1109, A2-s1110, A2-s1111, A2-s1112, A2-s1113, A2-s1114, A2-s1115, A2-s1116, A2-s1117, A2-s1118, A2-s1119, A2-s1120, A2-s1121, A2-s1122, A2-s1123, A2-s1124, A2-s1125, A2-s1126, A2-s1127, A2-s1128, A2-s1129, A2-s1130, A2-s1131, A2-s1132, A2-s1133, A2-s1134, A2-s1135, A2-s1136, A2-s1137, A2-s1138, A2-s1139, A2-s1140, A2-s1141, A2-s1142, A2-s1143, A2-s1144, A2-s1145, A2-s1146, A2-s1147, A2-s1148, A2-s1149, A2-s1150, A2-s1151, A2-s1152, A2-s1153, A2-s1154, A2-s1155, A2-s1156, A2-s1157, A2-s1158, A2-s1159, A2-s1160, A2-s1161, A2-s1162, A2-s1163, A2-s1164, A2-s1165, A2-s1166, A2-s1167, A2-s1168, A2-s1169, A2-s1170, A2-s1171, A2-s1172, A2-s1173, A2-s1174, A2-s1175, A2-s1176, A2-s1177, A2-s1178, A2-s1179, A2-s1180, A2-s1181, A2-s1182, A2-s1183, A2-s1184, A2-s1185, A2-s1186, A2-s1187, A2-s1188, A2-s1189, A2-s1190, A2-s1191, A2-s1192, A2-s1193, A2-s1194, A2-s1195, A2-s1196, A2-s1197, A2-s1198, A2-s1199, A2-s1200, A2-s1201, A2-s1202, A2-s1203, A2-s1204, A2-s1205, A2-s1206, A2-s1207, A2-s1208, A2-s1209, A2-s1210, A2-s1211, A2-s1212, A2-s1213, A2-s1214, A2-s1215, A2-s1216, A2-s1217, A2-s1218, A2-s1219, A2-s1220, A2-s1221, A2-s1222, A2-s1223, A2-s1224, A2-s1225, A2-s1226, A2-s1227, A2-s1228, A2-s1229, A2-s1230, A2-s1231, A2-s1232, A2-s1233, A2-s1234, A2-s1235, A2-s1236, A2-s1237, A2-s1238, A2-s1239, A2-s1240, A2-s1241, A2-s1242, A2-s1243, A2-s1244, A2-s1245, A2-s1246, A2-s1247, A2-s1248, A2-s1249, A2-s1250, A2-s1251, A2-s1252, A2-s1253, A2-s1254, A2-s1255, A2-s1256, A2-s1257, A2-s1258, A2-s1259, A2-s1260, A2-s1261, A2-s1262, A2-s1263, A2-s1264, A2-s1265, A2-s1266, A2-s1267, A2-s1268, A2-s1269, A2-s1270, A2-s1271, A2-s1272, A2-s1273, A2-s1274, A2-s1275, A2-s1276, A2-s1277, A2-s1278, A2-s1279, A2-s1280, A2-s1281, A2-s1282, A2-s1283, A2-s1284, A2-s1285, A2-s1286, A2-s1287, A2-s1288, A2-s1289, A2-s1290, A2-s1291, A2-s1292, A2-s1293, A2-s1294, A2-s1295, A2-s1296, A2-s1297, A2-s1298, A2-s1299, A2-s1300, A2-s1301, A2-s1302, A2-s1303, A2-s1304, A2-s1305, A2-s1306, A2-s1307, A2-s1308, A2-s1309, A2-s1310, A2-s1311, A2-s1312, A2-s1313, A2-s1314, A2-s1315, A2-s1316, A2-s1317, A2-s1318, A2-s1319, A2-s1320, A2-s1321, A2-s1322, A2-s1323, A2-s1324, A2-s1325, A2-s1326, A2-s1327, A2-s1328, A2-s1329, A2-s1330, A2-s1331, A2-s1332, A2-s1333, A2-s1334, A2-s1335, A2-s1336, A2-s1337, A2-s1338, A2-s1339, A2-s1340, A2-s1341, A2-s1342, A2-s1343, A2-s1344, A2-s1345, A2-s1346, A2-s1347, A2-s1348, A2-s1349, A2-s1350, A2-s1351, A2-s1352, A2-s1353, A2-s1354, A2-s1355, A2-s1356, A2-s1357, A2-s1358, A2-s1359, A2-s1360, A2-s1361, A2-s1362, A2-s1363, A2-s1364, A2-s1365, A2-s1366, A2-s1367, A2-s1368, A2-s1369, A2-s1370, A2-s1371, A2-s1372, A2-s1373, A2-s1374, A2-s1375, A2-s1376, A2-s1377, A2-s1378, A2-s1379, A2-s1380, A2-s1381, A2-s1382, A2-s1383, A2-s1384, A2-s1385, A2-s1386, A2-s1387, A2-s1388, A2-s1389, A2-s1390, A2-s1391, A2-s1392, A2-s1393, A2-s1394, A2-s1395, A2-s1396, A2-s1397, A2-s1398, A2-s1399, A2-s1400, A2-s1401, A2-s1402, A2-s1403, A2-s1404, A2-s1405, A2-s1406, A2-s1407, A2-s1408, A2-s1409, A2-s1410, A2-s1411, A2-s1412, A2-s1413, A2-s1414, A2-s1415, A2-s1416, A2-s1417, A2-s1418, A2-s1419, A2-s1420, A2-s1421, A2-s1422, A2-s1423, A2-s1424, A2-s1425, A2-s1426, A2-s1427, A2-s1428, A2-s1429, A2-s1430, A2-s1431, A2-s1432, A2-s1433, A2-s1434, A2-s1435, A2-s1436, A2-s1437, A2-s1438, A2-s1439, A2-s1440, A2-s1441, A2-s1442, A2-s1443, A2-s1444, A2-s1445, A2-s1446, A2-s1447, A2-s1448, A2-s1449, A2-s1450, A2-s1451, A2-s1452, A2-s1453, A2-s1454, A2-s1455, A2-s1456, A2-s1457, A2-s1458, A2-s1459, A2-s1460, A2-s1461, A2-s1462, A2-s1463, A2-s1464, A2-s1465, A2-s1466, A2-s1467, A2-s1468, A2-s1469, A2-s1470, A2-s1471, A2-s1472, A2-s1473, A2-s1474, A2-s1475, A2-s1476, A2-s1477, A2-s1478, A2-s1479, A2-s1480, A2-s1481, A2-s1482, A2-s1483, A2-s1484, A2-s1485, A2-s1486, A2-s1487, A2-s1488, A2-s1489, A2-s1490, A2-s1491, A2-s1492, A2-s1493, A2-s1494, A2-s1495, A2-s1496, A2-s1497, A2-s1498, A2-s1499, A2-s1500, A2-s1501, A2-s1502, A2-s1503, A2-s1504, A2-s1505, A2-s1506, A2-s1507, A2-s1508, A2-s1509, A2-s1510, A2-s1511, A2-s1512, A2-s1513, A2-s1514, A2-s1515, A2-s1516, A2-s1517, A2-s1518, A2-s1519, A2-s1520, A2-s1521, A2-s1522, A2-s1523, A2-s1524, A2-s1525, A2-s1526, A2-s1527, A2-s1528, A2-s1529, A2-s1530, A2-s1531, A2-s1532, A2-s1533, A2-s1534, A2-s1535, A2-s1536, A2-s1537, A2-s1538, A2-s1539, A2-s1540, A2-s1541, A2-s1542, A2-s1543, A2-s1544, A2-s1545, A2-s1546, A2-s1547, A2-s1548, A2-s1549, A2-s1550, A2-s1551, A2-s1552, A2-s1553, A2-s1554, A2-s1555, A2-s1556, A2-s1557, A2-s1558, A2-s1559, A2-s1560, A2-s1561, A2-s1562, A2-s1563, A2-s1564, A2-s1565, A2-s1566, A2-s1567, A2-s1568, A2-s1569, A2-s1570, A2-s1571, A2-s1572, A2-s1573, A2-s1574, A2-s1575, A2-s1576, A2-s1577, A2-s1578, A2-s1579, A2-s1580, A2-s1581, A2-s1582, A2-s1583, A2-s1584, A2-s1585, A2-s1586, A2-s1587, A2-s1588, A2-s1589, A2-s1590, A2-s1591, A2-s1592, A2-s1593, A2-s1594, A2-s1595, A2-s1596, A2-s1597, A2-s1598, A2-s1599, A2-s1600, A2-s1601, A2-s1602, A2-s1603, A2-s1604, A2-s1605, A2-s1606, A2-s1607, A2-s1608, A2-s1609, A2-s1610, A2-s1611, A2-s1612, A2-s1613, A2-s1614, A2-s1615, A2-s1616, A2-s1617, A2-s1618, A2-s1619, A2-s1620, A2-s1621, A2-s1622, A2-s1623, A2-s1624, A2-s1625, A2-s1626, A2-s1627, A2-s1628, A2-s1629, A2-s1630, A2-s1631, A2-s1632, A2-s1633, A2-s1634, A2-s1635, A2-s1636, A2-s1637, A2-s1638, A2-s1639, A2-s1640, A2-s1641, A2-s1642, A2-s1643, A2-s1644, A2-s1645, A2-s1646, A2-s1647, A2-s1648, A2-s1649, A2-s1650, A2-s1651, A2-s1652, A2-s1653, A2-s1654, A2-s1655, A2-s1656, A2-s1657, A2-s1658, A2-s1659, A2-s1660, A2-s1661, A2-s1662, A2-s1663, A2-s1664, A2-s1665, A2-s1666, A2-s1667, A2-s1668, A2-s1669, A2-s				

## E ADDITIVAZIONE DELL'ACQUA

Prima della messa in funzione dell'impianto di ricambio, dovrà essere eseguito un lavaggio del ciclo termico al fine di eliminare ogni residuo di lavorazione e quant'alto di solido ed amaro presente al suo interno. Il circuito, dopo aver circolato per almeno 10 minuti, dovrà essere drenato e l'acqua scaricata. Si deve procedere a riempimento nuovamente con acqua additivata con un prodotto sgrassante, detergente e dispendente da aggiungersi in ragione di 1 kg per m<sup>3</sup> di riempimento. Poi, dopo aver fatto circolare il tutto per 3-5 giorni circa, si deve prescrivere nuovamente il lavaggio del circuito. Infine occorre riempire l'impianto additivandolo con il prodotto antiruggine che è antiscorbo (come prescritto dalla Norma UNI 8085, in ragione di 5 kg per m<sup>3</sup> di riempimento).

Le operazioni di lavaggio e di additivazione dovranno essere ripetute periodicamente, in presenza di un circuito progettato per agevolare lo spurgo della sporcizia, è necessaria per garantire nel tempo un ottimale funzionamento dell'impianto senza incorrere nei problemi dovuti all'accumulo di prodotti di ossidazione. I risultati si faranno l'ora messa in funzione, creando nel tempo occasioni e comorioni.

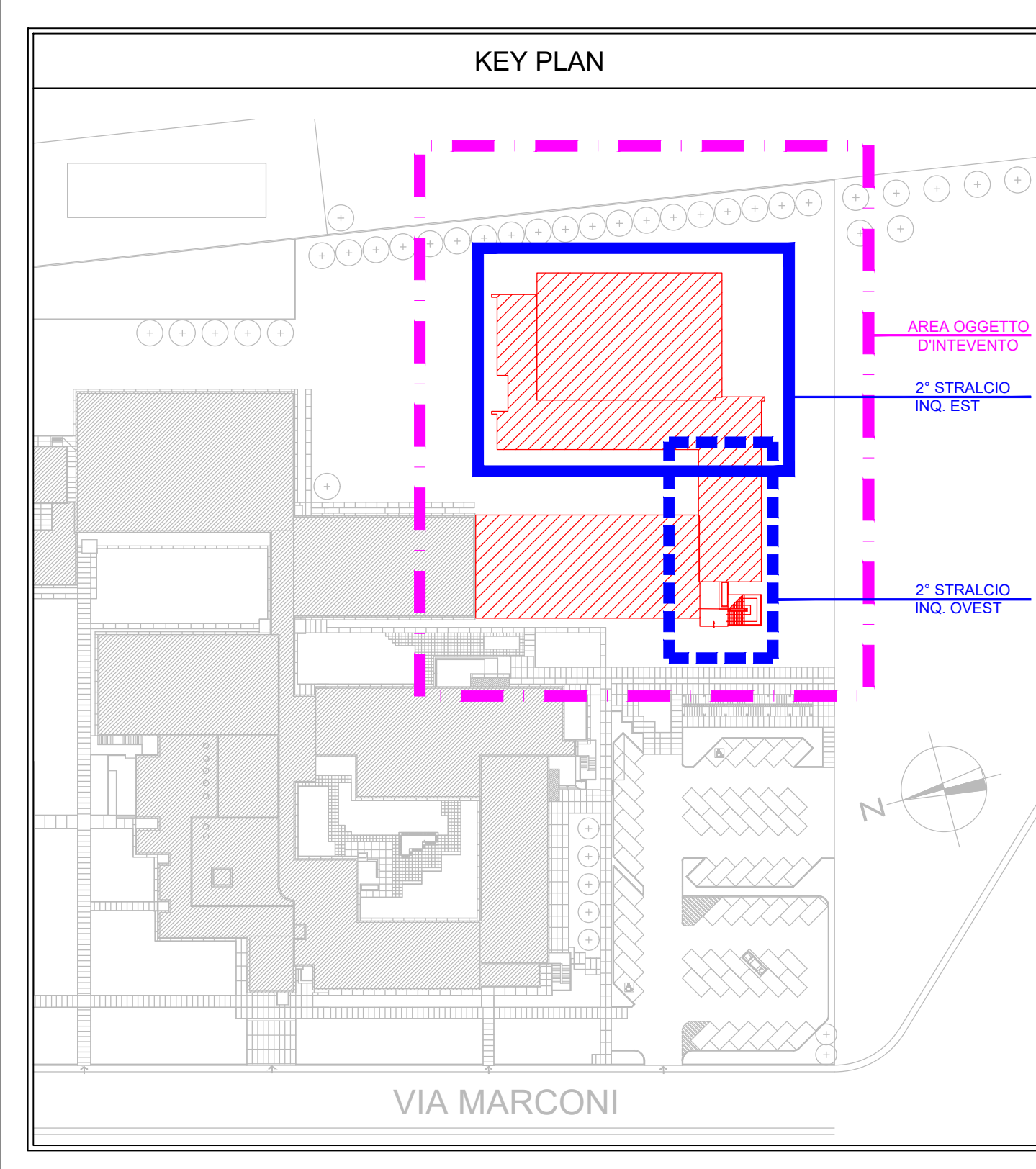
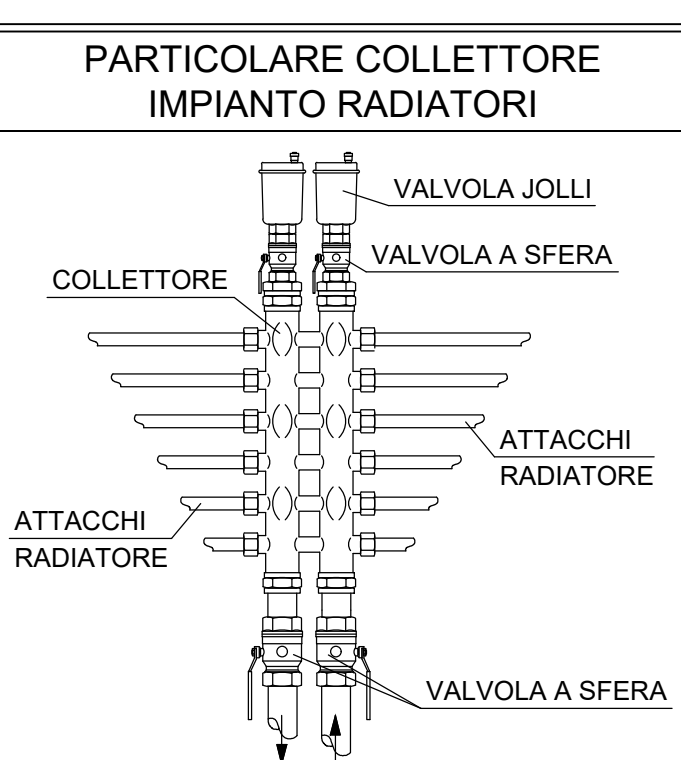
[illegible]